

Step-by-Step Tutorial: How to Make a Fleece Dog Coat 🐕 🧵

Making a fleece dog coat at home is an easy and rewarding sewing project. This tutorial is based on the reference layout and measurements shown in the diagram above, adapted into a complete beginner-friendly guide for people in the United States. The coat is warm, comfortable, adjustable, and perfect for small dogs during cold weather.

STEP-BY-STEP TUTORIAL: HOW TO MAKE A FLEECE DOG COAT

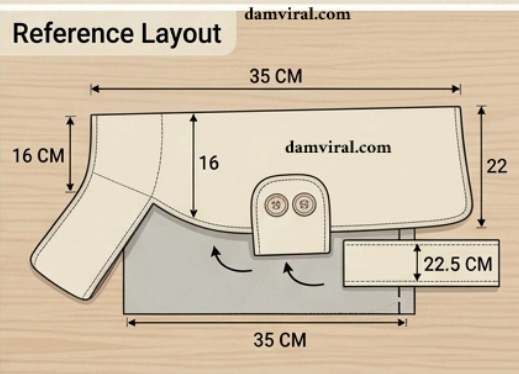

STEP 1: CUT 1 MAIN BODY (ON FOLD) & 2 BELLY STRAPS
(CM: BACK 35, NECK 16, BELLY FLAP 22)

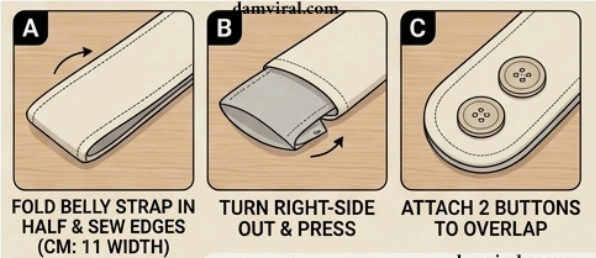
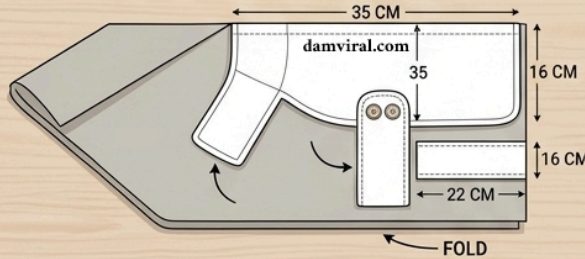

STEP 3: ASSEMBLY

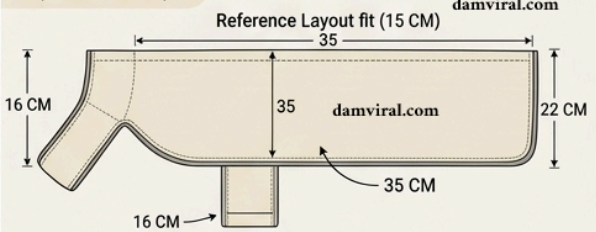
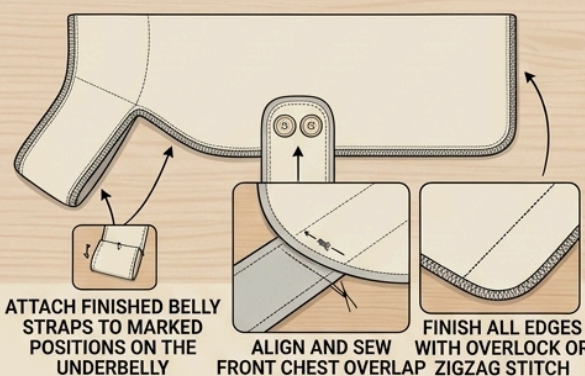

STEP 4: DETAILS

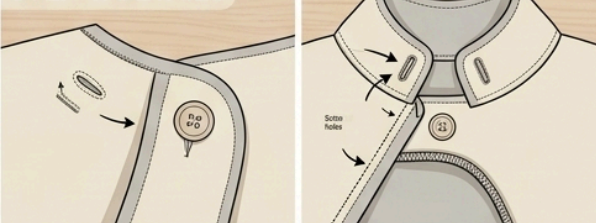

KEY US SEWING & QUILTING METHODS

- OVERLOCK STITCH** To encase raw edges, prevent fraying.
- STITCH IN THE DITCH** Precise stitching for invisible hold (e.g., collar seams).
- TOPSTITCHING** Decorative and reinforces edges.
- WALKING FOOT** Essential for multi-layer heavy fabrics (like fleece with lining).
- MACHINE QUILTING** (Optional) for a layered variation.

- <https://handcrafted.craftsforlove.com/> SEE THE BEST PATTERNS

The finished coat features:

- A soft fleece outer layer
- A wrap-around belly strap with button closure
- A curved neck opening for comfort
- Rounded edges for a professional finish
- Simple construction suitable for beginners

This guide uses inches and centimeters when helpful.

Materials and Tools You Will Need

Before starting, gather all supplies.

Fabric

- Polar fleece or anti-pill fleece
- Recommended amount:
 - 1/2 yard (45 cm) for small dogs
 - More for medium or large dogs

Optional:

- Sherpa lining
- Quilted batting
- Waterproof outer fabric

Sewing Supplies

- Sewing machine
- Polyester thread
- Fabric scissors
- Measuring tape
- Fabric chalk or washable marker
- Pins or sewing clips
- Iron and ironing board
- Hand sewing needle
- 2 medium buttons or snaps

Optional but recommended:

- Walking foot for thick fleece
- Overlock/serger machine

- <https://handcrafted.craftsforlove.com/> SEE THE BEST PATTERNS

Understanding the Coat Layout

The coat consists of:

1. Main body piece
2. Belly strap
3. Neck/chest extension
4. Button closure overlap

The original reference measurements are:

- Back length: 35 cm (13.8 inches)
- Neck height: 16 cm (6.3 inches)
- Belly flap width: 22 cm (8.7 inches)
- Belly strap width before folding: 11 cm (4.3 inches)

These measurements fit a small dog similar to the example shown.

How to Measure Your Dog

Before cutting fabric, measure your dog carefully.

Back Length

Measure from:

- Base of neck
to
- Base of tail

Chest Girth

Measure around the widest part of the chest.

Neck Circumference

Measure loosely around the neck area.

Belly Position

Check where the belly strap should sit comfortably behind the front legs.

Always add:

- 1/2 inch seam allowance
- 1–2 inches ease for comfort

- <https://handcrafted.craftsforlove.com/> SEE THE BEST PATTERNS

Step 1: Cut the Main Body and Belly Straps

Fold your fleece fabric in half with the right sides facing inward.

Using chalk, draw the pattern directly onto the fabric.

Main Body Measurements

Create a body piece approximately:

- 35 cm long
- 22 cm tall at the back
- 16 cm neck section

Shape the front neck opening with a smooth curve as shown in the reference image.

Round the back corners slightly for a softer finish.

Belly Strap Pieces

Cut:

- 2 rectangular belly straps

Suggested size:

- 22 cm long
- 11 cm wide before folding

These straps will wrap underneath the dog.

Important Tip

Cut slowly and keep curves smooth. Uneven curves are very noticeable on finished fleece projects.

Step 2: Sew the Belly Straps

Take each belly strap and fold it lengthwise with right sides together.

Sewing the Strap

Sew along:

- The long edge
- One short edge

Leave one short edge open for turning.

- <https://handcrafted.craftsforlove.com/> SEE THE BEST PATTERNS

Use:

- 1/4 inch seam allowance

Turn Right Side Out

After sewing:

- Turn the strap right-side out
- Push corners gently using a blunt tool
- Press flat with low heat

Fleece can melt under high heat, so always use low temperature.

Add Buttons

Attach:

- 2 buttons to the rounded overlap side

Alternative closures:

- Velcro
- Plastic snaps
- Heavy-duty hook and loop tape

Step 3: Prepare the Main Coat Body

Take the main body piece and fold or layer it according to your fabric design.

If adding lining:

- Place outer fleece and lining right sides together

Sew around the outer edges, leaving a small opening for turning.

Turn right-side out and press gently.

Finish the Edges

You can finish edges using:

- Zigzag stitch
- Overlock stitch
- Bias binding
- Topstitching

Topstitching gives the coat a clean professional appearance and helps the layers stay flat.

- <https://handcrafted.craftsforlove.com/> SEE THE BEST PATTERNS

Step 4: Attach the Belly Straps

Place the belly straps underneath the coat body in the marked belly position.

The straps should:

- Sit behind the front legs
- Wrap comfortably around the stomach

Pin in Place

Check alignment carefully before sewing.

Sew Securely

Stitch the straps firmly using:

- Box stitch
- Reinforced X stitch

These areas receive the most pulling force during wear.

Step 5: Create the Front Chest Overlap

The front chest section wraps slightly across the dog's chest.

Align the curved front pieces neatly.

Sew carefully along the overlap area while maintaining smooth curves.

This section helps:

- Keep warmth inside
- Prevent shifting during walking

Step 6: Add Buttonholes or Fasteners

Mark the buttonhole positions on the opposite belly flap.

Make sure:

- The coat fits snugly
- The dog can still move comfortably

- <https://handcrafted.craftsforlove.com/> SEE THE BEST PATTERNS

Test Fit First

Before sewing buttonholes:

- Put the coat on the dog
- Adjust fit if needed

A properly fitted coat should:

- Stay in place
- Not restrict movement
- Not sag underneath

Step 7: Finish All Edges ✨

Finish every raw edge to prevent fraying and improve durability.

Recommended methods:

Overlock Stitch

Best for:

- Fleece
- Stretch fabrics

Provides:

- Clean edge
- Professional finish

Zigzag Stitch

A good option for standard sewing machines.

Topstitching

Adds:

- Strength
- Decorative detail
- Better structure

Sew slowly around curves for the best results.

- <https://handcrafted.craftsforlove.com/> SEE THE BEST PATTERNS

Optional Upgrades

You can customize the coat with extra features.

Add a Collar

Create a soft standing collar for extra warmth.

Add Reflective Tape

Useful for:

- Night walks
- Winter visibility

Add Waterproof Layer

Perfect for:

- Snow
- Rain
- Wet climates

Add Quilted Insulation

For colder regions, insert:

- Batting
- Thermal lining

Sewing Tips for Beginners

Use Polyester Thread

It stretches slightly and works well with fleece.

Use Clips Instead of Pins

Fleece can shift easily.

Sew Slowly on Curves

Sharp curves are the trickiest part of the project.

Test on Scrap Fabric First

Always test:

- <https://handcrafted.craftsforlove.com/> SEE THE BEST PATTERNS

- Stitch tension
- Needle size
- Fabric feeding

Recommended Sewing Machine Settings

For fleece fabric:

- Stitch length: 3.0–3.5 mm
- Needle:
 - Universal 90/14
 - Ballpoint needle

Reduce pressure if the fabric stretches while sewing.

Washing and Care Instructions

Wash:

- Cold or warm water
- Gentle cycle

Avoid:

- High dryer heat

Air drying is best for fleece longevity.

Final Fit Checklist

Your finished dog coat should:

- Cover the back comfortably
- Allow free movement
- Stay secure during walking
- Sit flat without twisting
- Keep the chest and belly warm

Beginner Time Estimate

- Cutting: 30–45 minutes
- Sewing: 1–2 hours
- Finishing: 30 minutes

Total:

- Around 2–3 hours for beginners

- <https://handcrafted.craftsforlove.com/> SEE THE BEST PATTERNS

Conclusion 🐕❤️

This fleece dog coat is an excellent beginner sewing project that combines comfort, functionality, and style. With simple materials and careful measuring, you can create a warm custom-fit coat for your dog at home.

Once you finish your first version, you can easily make:

- Winter coats
- Rain jackets
- Holiday-themed outfits
- Reversible fleece coats