

Crafting Your Denim & Button Flower Bag: Complete Step-by-Step Tutorial

This detailed tutorial will guide you through creating a charming denim tote bag with decorative button flowers. All measurements are in **centimeters (cm)** to match the original pattern.

CRAFTING YOUR DENIM & BUTTON FLOWER BAGS: A STEP-BY-STEP TUTORIAL

LEGEND OF KEY SEWING & QUILT METHODS (US Terminology)

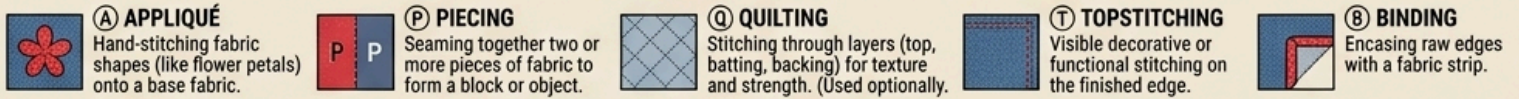

1 GATHER & MEASURE MATERIALS (All measurements are CM)

MATERIAL SWATCHES

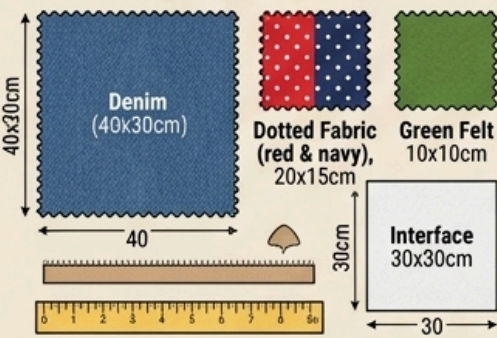

SUPPLIES



2 PATTERN & CUTTING

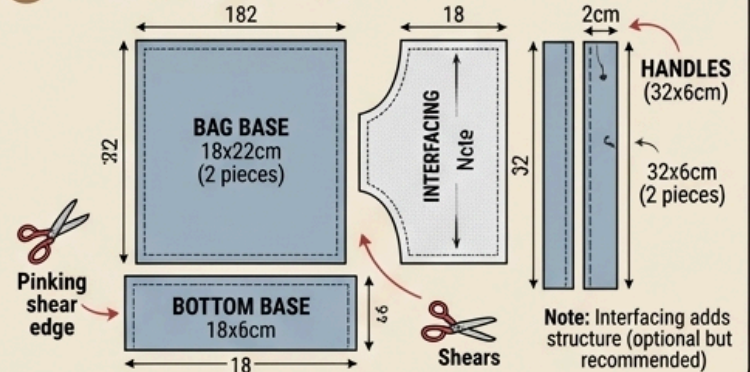

3 MAKE THE BUTTON FLOWERS

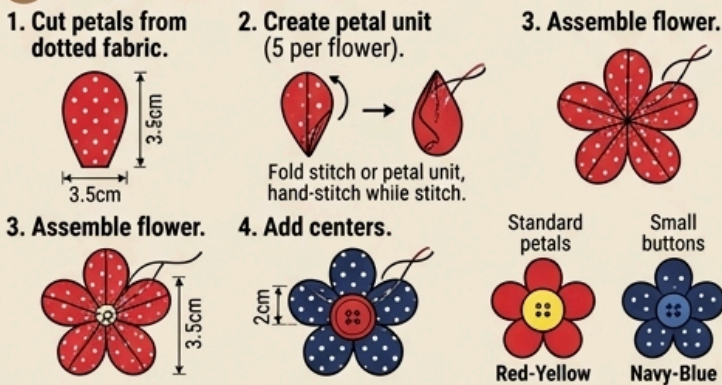

4 APPLIQUÉ & BAG BODY ASSEMBLY

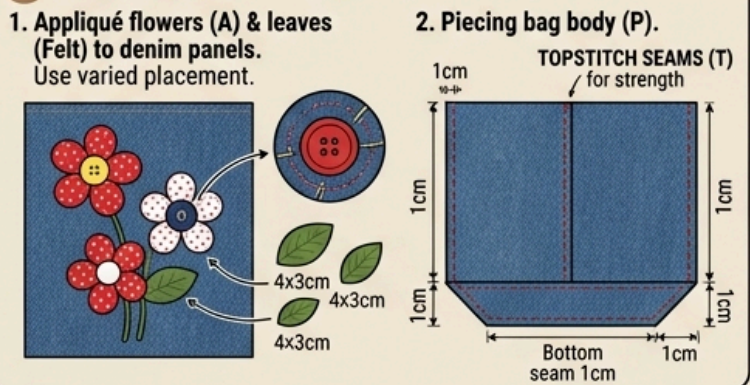

3. Attach Binding (B) and Handles (P).

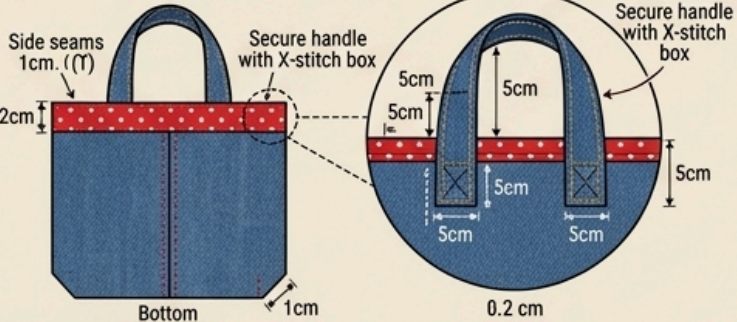

5 FINAL FINISHING & OPTIONAL LINING

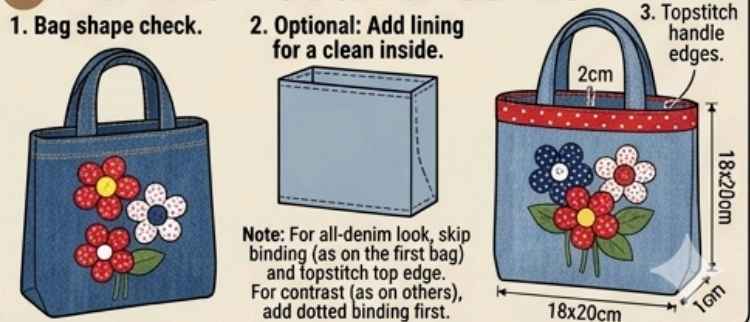



Step 1: Gather & Measure Materials

Fabric Pieces

Prepare the following:

- **Denim Fabric:** 40 × 30 cm
- **Dotted Cotton Fabric (Red & Navy):** 20 × 15 cm
- **Green Felt:** 10 × 10 cm
- **Interfacing:** 30 × 30 cm (optional but recommended for structure)

Supplies

You will also need:

- Assorted buttons (various sizes for flower centers)
- Matching thread
- Needle
- Fabric marking tool (chalk or pen)
- Scissors or pinking shears
- Ruler



Step 2: Pattern & Cutting

Cut your fabric according to these measurements:

Main Pieces

- **Bag Base (Denim):** 18 × 22 cm (cut 2 pieces)
- **Bottom Base (Denim):** 18 × 6 cm (cut 1 piece)

Handles

- Cut 2 strips: 32 × 6 cm each

Interfacing

- Cut to match bag panels (optional but adds durability)

Notes

- Use **pinking shears** to reduce fraying if available
- Mark seam allowances (1 cm standard)



Step 3: Make the Button Flowers

1. Cut Petals

- From dotted fabric, cut petal shapes approximately **3.5 cm tall**

2. Create Petal Units

- Fold each petal and stitch at the base
- Make **5 petals per flower**

3. Assemble Flowers

- Stitch petals together in a circular shape
- Add a button in the center

4. Add Variations

- Mix colors (red-yellow, navy-blue)
- Use different button sizes for visual interest



Step 4: Appliqué & Bag Body Assembly

1. Attach Flowers & Leaves

- Cut **leaf shapes (4 × 3 cm)** from green felt
- Arrange flowers and leaves on one denim panel
- Hand-stitch or machine stitch (appliqué method)

2. Assemble Bag Body

- Sew the two denim panels together (right sides facing)
- Attach the bottom base piece
- Use a **1 cm seam allowance**

3. Reinforce Seams

- Turn bag right side out
- Add **topstitching** along seams for strength and decoration

Step 5: Attach Binding & Handles

Binding

- Use dotted fabric strips to bind the top edge
- Fold over raw edges and stitch neatly

Handles

1. Fold each handle strip lengthwise and stitch
2. Turn right side out and press flat
3. Attach to bag:
 - Position handles **5 cm from each side**
 - Secure with an **X-stitch box** for strength

Step 6: Final Finishing & Optional Lining

1. Shape Check

- Ensure corners are properly formed
- Adjust seams if needed

2. Optional Lining

- Create a simple inner lining using same dimensions
- Insert and stitch into top edge for a clean finish

3. Final Touches

- Topstitch around the top edge
- Reinforce handle attachments if needed

Finished Bag Dimensions

- Approximate size: **18 × 20 cm**
- Structured, decorative, and perfect for everyday use!

Tips for Success

- Take your time with the appliqué—it adds personality
- Use interfacing for a sturdier bag
- Mix button styles for a unique look
- Press fabric as you go for cleaner seams