

Mix and Match Blocks

Four really useful patchwork blocks have been created for you to make a wide range of lovely items. There is a flower, a leaf, a bee and a bird for you to play with. Including their borders, the motifs all create blocks of the same size, 13in x 12in (33cm x 30.5cm), so it is easy to combine them and mix and match to your heart's content. To provide ideas to get you going we have designed some quilts using these blocks – the Flower Meadow Quilt, the Flowers and Bees Quilt and the Adore You Baby Quilt. The quilts use fabrics mostly from the Happy Campers and Meadow Basics collections but you could easily use fabrics from other Tilda ranges. All of the instructions for the blocks and the quilts are available from www.tildasworld.com.

The Bird Block

In the Happy Campers quilts, the Bird block is used in two different colourways. Sometimes the block is reversed (flipped) so it faces the other way. Only one version of the block is described here. For the specific fabrics and the total fabric quantities to use, refer to the quilt instructions.

Materials

- A solid fabric for the background (see **Fig B** for sizes to cut)
- A solid fabric for the beak
- Five print fabrics
- Black stranded embroidery cotton (floss) for the eye

Making a Bird Block

1 The Bird block is used in two colourways in the Flower Meadow Quilt and in two colourways in the Adore You Baby Quilt. The layout is shown in **Fig A**. This diagram also shows fabrics but these will need to change depending on the project you are making. The block may also be used in a reversed (flipped) layout but details of this are given in the relevant quilt projects. Follow **Fig B** carefully to cut the pieces needed for a block.

Fig A Bird fabric layout

The fabrics used will need to change depending on the project you are making

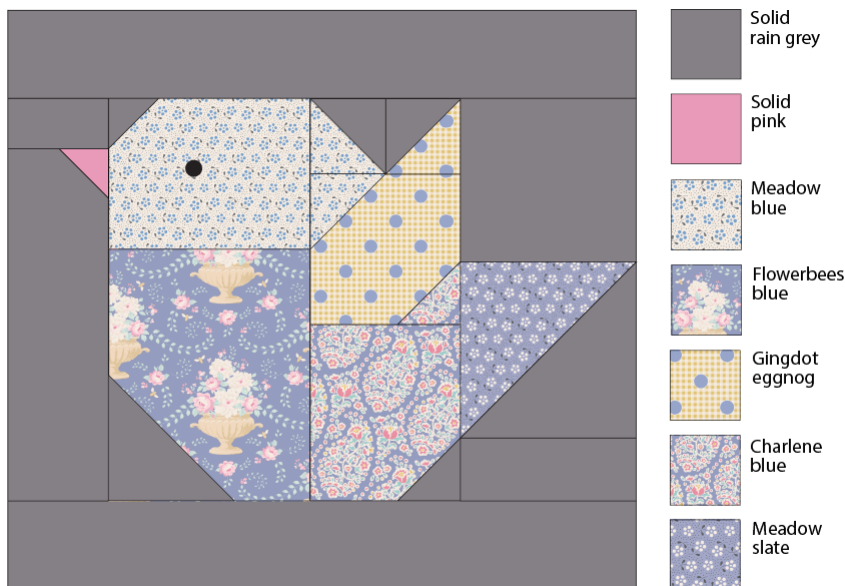
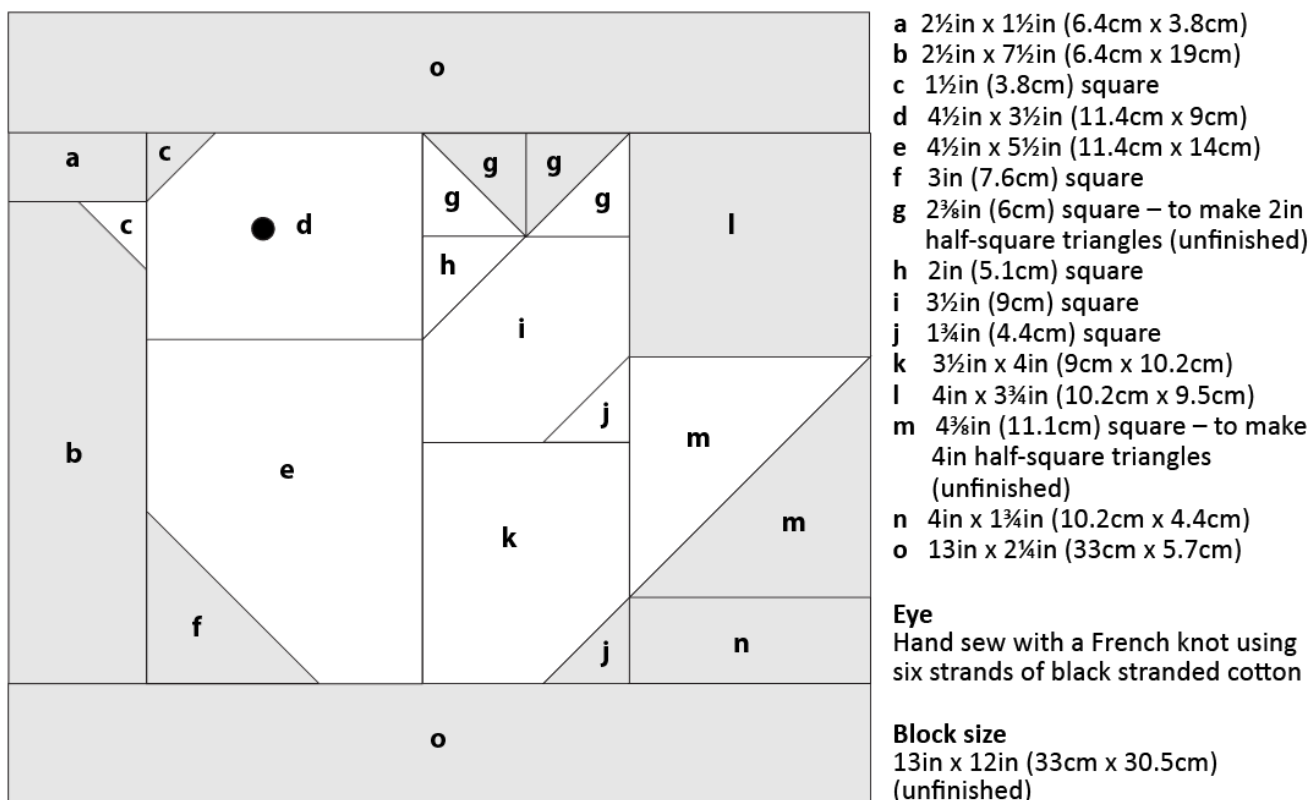

Fig B Layout and cutting for a Bird block

Sizes include seam allowances

All pieces to be cut as squares or rectangles



2 The block uses units that have a triangle created on a corner, so we will show this technique first. Take a **b** rectangle and one **c** square. Pencil mark a diagonal line on the wrong side of the small square and place the square right sides together with the top right corner of the rectangle, with the marked line angled as shown in **Fig C**. Pin if needed and then sew along the marked line and trim off excess fabric ¼in (6mm) outside the sewn lines. Press the triangle outwards.

Fig C Making corner triangles

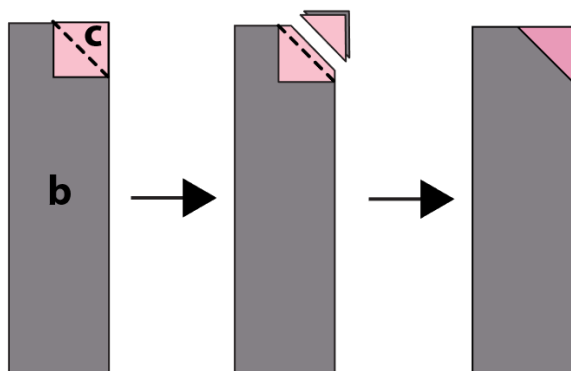

3 Four other units in the block need corner triangles using the same technique – see **Fig D** for the fabric and triangle positions.

Fig D Making the other corner triangle units

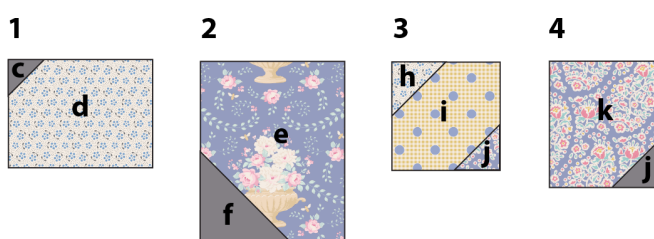

4 The other units to make are half-square triangles (HST). Make one HST as follows. Take one print **g** square and one solid **g** square and cut each square in half along one diagonal to make two triangles from each square (**Fig E 1**). Pair up two different triangles, place them right sides together and sew a $\frac{1}{4}$ in (6mm) seam along the long diagonal side. Press the seam open or to one side. Check the half-square triangle unit is 2in (5.1cm) square.

Repeat this to make a second HST unit, this time using the fabrics shown in **Fig E 2**.

Use this same HST technique and the **m** squares to make another HST unit (**Fig E 3**). This time, the unit should be 4in (10.2cm) square once sewn.

Fig E Making half-square triangles

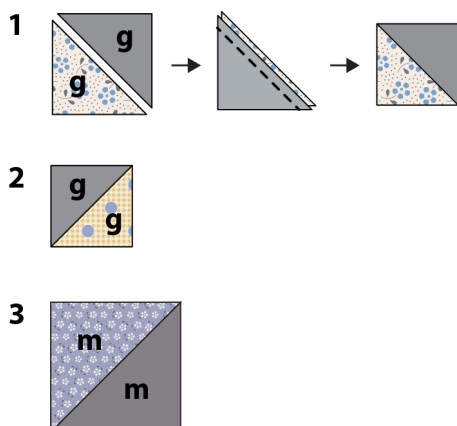

5 To assemble the block, take all of the units you have made, plus pieces **a**, **l** and **n** and arrange them into columns, as shown in **Fig F**. Sew the units together as shown, and press. Now sew the four columns together, as in **Fig G** and press.

Fig F Assembling the units into columns

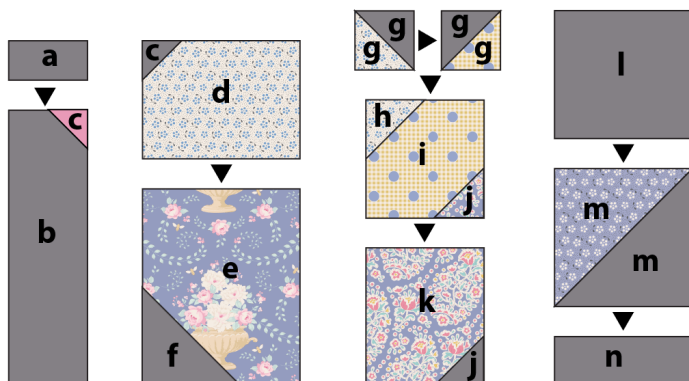
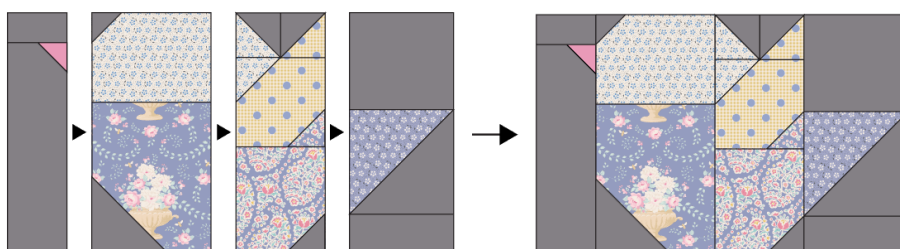
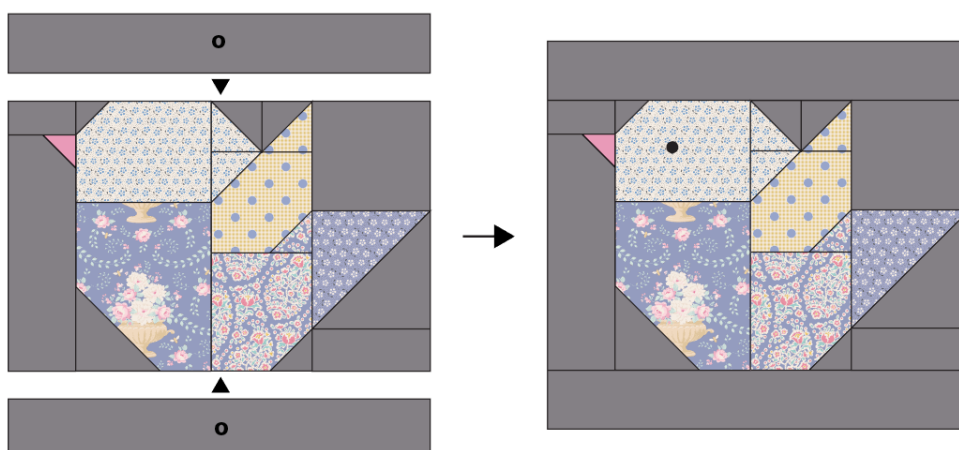

Fig G Sewing the columns together



6 To add the border, take the two **o** pieces and sew them to the top and bottom of the block (**Fig H**) and press. Check the block is 13in x 12in (33cm x 30.5cm).

Fig H Adding the border



Tip

If creating your own projects using the Mix and Match blocks, you can change the outer border sizes. This will allow you to make the border deeper if you wish, or change the fabric, or even create a pieced border.